

Help Save the Bluepeter Building and a part of Mission Bay History

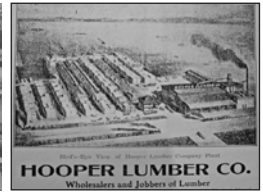

SLATED FOR DEMOLITION IN A SOON-TO-BE PUBLIC PARK IN MISSION BAY, **YOU CAN SPEAK OUT TO SAVE THE BUILDING FOR RE-USE WITHIN THE PARK.** History: Modern Industrial construction, built in 1943 on the last of the Bay fill, on the site of the Hooper Lumber Co. Wharf. Navy use during WWII; housed CJ Hendry Co. Ships Chandlers rigging dept. 1947-1961 (founded in 1890 at corner of Market/ Sacramento Sts.) plus internationally known Jotz Sail Makers 1970-1979 as well as other maritime users. 2001 SF Planning Dept. Cultural Resources study found that the building “should be given special consideration in local planning.” **SPEAK OUT NOW** to save one of two historic maritime structures in the Mission Bay project area for the use and enjoyment of future visitors to San Francisco’s eastern waterfront!



Help Save the Bluepeter Building and a part of Mission Bay History

A future meeting place at the crossroads of Dogpatch, Potrero Hill and Mission Bay!



The Bluepeter building located in southernmost tip of Mission Bay at intersection of Terry Francois Blvd./Mariposa St./Illinois St.

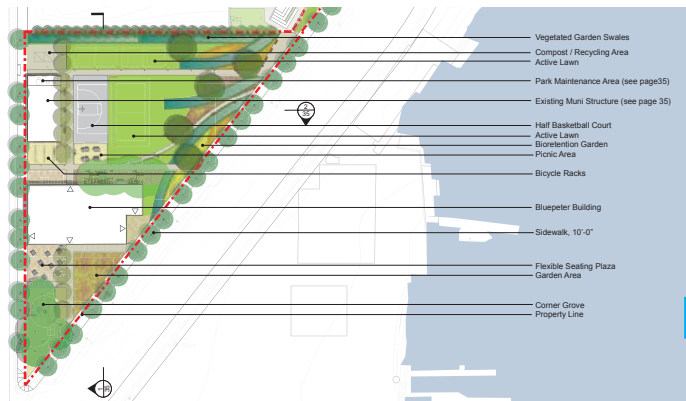

Landscape plan with Bluepeter building integrated into park



Architect Rendering of revitalized Bluepeter building for use in public serving capacity

Suggested Ideas from the community:

Food Service: Crab Shack, Café/Restaurant, Food Court, mobile food carts

Market/Retail: Farmers Market, Fish Market, Grocery/Gourmet Foods, Art/Sculpture Gallery, Marine related retail, Bookstore

Recreation: Kayak Rental, Bike Rental, Rec Center (fitness center, basket ball court)

Community: Meeting Space, Museum, Entertainment Venue

Education: Boat Repair/Building, Sail making, Maritime education

read more and see how you can help:

www.bluepetersf.org or contact: bluepeterp24@comcast.net

www.mydogpatch.org/group/bluepeterbuilding

